



1800 Series

Flatbar Exit Devices

introduction

Yale® 1800 series exit devices are the ideal choice for economy commercial applications where consistent quality, ease of use and installation are required.

1800(F) rim and 1810(F) surface vertical rod devices are certified ANSI/BHMA A156.3, Grade 1 and their performance, construction and versatility make them perfect for a variety of facilities.

iso 9001

Designed and manufactured under a certified ISO 9001 quality system.

ansi/bhma

Certified ANSI/BHMA A156.3, Grade 1.



fire listings

1800 series exit devices are UL-cUL Listed for use on fire doors having a rating up to and including 3-hours.

Note: Any retrofit or other field modification to a fire rated opening can potentially impact the fire rating of the opening, and Yale Locks & Hardware makes no representations or warranties concerning what such impact may be in any specific situation. When retrofitting any portion of an existing fire rated opening, or specifying and installing a new fire-rated opening, please consult with a code specialist or local code official (Authority Having Jurisdiction) to ensure compliance with all applicable codes and ratings.

free wheeling lever trim

1800 series exit device lever trims feature the unique Free Wheeling lever mechanism. This Free Wheeling trim features a clutch mechanism which allows the lever to float down 60° when operated in the locked condition, greatly improving vandal resistance.



exit device applications

Single Door

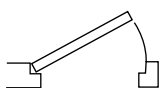

Rim Exit Device

- ANSI/BHMA A156.3 Type 1
- Easy installation
- Flush or wide stile metal, wood or composite doors
- Non-handed
- Exit only or with entry trim

Pairs of Doors



One Rim - One Vertical Rod Exit Device

- An economic solution for light traffic openings
- Flush or wide stile metal, wood or composite doors
- Non-handed
- Emergency exit only

Pairs of Doors with Center Mullion

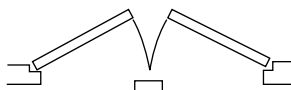

Two Rim Exit Devices - One Removable Mullion

- ANSI/BHMA A156.3 Type 1 and Type 22
- Easy installation
- Flush or wide stile metal, wood or composite doors
- Non-handed
- Exit only or with entry trim

Pairs of Doors or Double Egress Opening

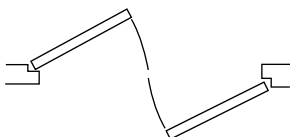

Two Surface Vertical Rod Exit Devices

- ANSI/BHMA A156.3 Type 2
- Two-point latch security
- Flush or wide stile metal, wood or composite doors
- Smoke control or fire exits
- Two-way traffic control

contents

Introduction	2
Finishes	2
Trim Applications	3
Facts and Figures	3
Rim Device	4
Surface Vertical Rod Device	5
Outside Trim	6-7
Cylinders	8-9
Strikes	10
Accessories	11
Mullions	12-13
How to Order	14

finishes

ANSI/BHMA Code	Finish Description
626*	Satin Chrome Plated
689	Aluminum Painted
691	Light Bronze Painted
693	Black Painted
695	Dark Bronze Painted

*Trim only finish option.

Note: Exit device latchhead cover and end caps provided in black for all finishes.

warranty

The 1800 series exit devices and escutcheon trim carry a one-year warranty. Cylindrical Trims carry a two-year warranty.



trim applications

ANSI types 1 (Rim) and 2 (Surface Vertical Rod) exit device requirements are met (or exceeded) by 1800(F) and 1810(F) respectively. Any of these exit devices may be used with any of the trim on the following chart. Trims are charted according to ANSI trim function and illustrations show typical function features, rather than pictorial renderings of the trims listed. Specific trim details are shown on pages 6-7.

Trim	Device (ANSI)	Rim (Type 1)		SVR (Type 2)	
	Options	1800(F) (Page 4)		1810(F) (Page 5)	
ANSI	Function				
01	Exit Only, No Trim/ Exit Only, Blank Plate		420F		420F
02	Pull to Open (Dummy Trim)		214F 448F* 428F* 449F* 429F		214F 448F* 428F* 449F* 429F
03	Key Retracts Latchbolts (NL)		213F 427F 217F 441F 421F		213F 427F 217F 441F 421F
08	Entrance by Lever (Key Locks/Unlocks Lever)		426F 446F		426F 446F
09	Key Unlocks Lever (Key Removable When Locked)		426F*		426F*
14	Lever Always Active (Passage)		428F 448F		428F 448F

*Trims marked with an asterisk on the Application Chart require an easy field change to adapt them for the charted function.

facts and figures

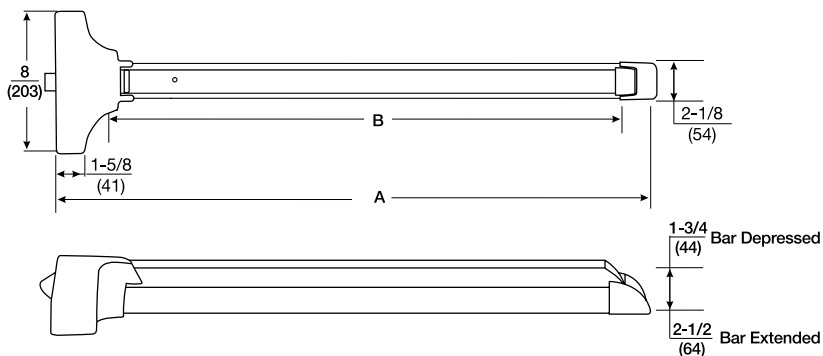

Device Size	"A"	"B"
36"	33" (84cm)	27" (69cm)
42"	39" (99cm)	33" (84cm)
48"	45" (114cm)	39" (99cm)

rim

1800(F)

The 1800(F) is a rim exit device to be used with single doors or pairs of doors constructed of metal, wood or composite materials. The 1800(F) can be paired with a wide variety of trims to meet many applications.



certification/compliance

UL/cUL Listed: FVSR/FVSR7 - Panic hardware
GXHX/GXHX7 - Fire exit hardware (F)
(4' x 8' single, 8' x 8' pairs, 3 hr.)

ANSI/BHMA Certified: A156.3 Type 1, Grade 1



features

- Designed for wide stile doors
- Non-handed for easy installation
- Steel interlock "E" bracket maintains door-to-mullion relationship in fire-labeled devices

applications

- Single swing doors
- Pairs of doors (mullion required)
- Metal, wood or composite door materials

specifications

Door Opening Width:	-36 for 30" - 36" (76cm - 91cm) doors -42 for 36" - 42" (91cm - 107cm) doors -48 for 42" - 48" (107cm - 122cm) doors
Door Thickness:	1-3/4" (44mm) standard. Refer to page 10 for other door thicknesses
Minimum Stile Width:	4-1/2" (114mm)
Projection:	2-1/2" (64mm) active, 1-3/4" (44mm) depressed
Strike:	757F, 793 optional (double door application)
Trims:	210F series utility trim, 420F series escutcheon trim, 440F series rose trim
Dogging:	Hex key dogging supplied standard on panic devices
Finishes:	689, 691, 693, 695
Options:	Shim Kit #223, Sex Nuts and Bolts
Warranty:	1-year limited



surface vertical rod

1810(F)

The 1810(F) is a surface vertical rod exit device to be used on metal, wood or composite pairs of doors up to 8' where two-point latching is desired.

certification/compliance

UL/cUL Listed: FVSR/FVSR7 - Panic hardware
GXHX/GXHX7 - Fire exit hardware (F)
(8' x 8' pairs, 3 hr.)

ANSI/BHMA

Certified: A156.3 Type 2, Grade 1 



features

- Designed for wide stile and flush doors
- Handed, specify hand (field reversible)
- Positive action linkage on a deadlocking top Pullman bolt
- Simultaneous direct pull bottom deadbolt
- When unlatched, device keeps both bolts retracted until door is shut.

applications

- Pairs of doors
- Double egress
- Metal, wood or composite door materials

specifications

- Door Opening Width: -36 for 30" - 36" (76cm - 91cm) doors
-42 for 36" - 42" (91cm - 107cm) doors
-48 for 42" - 48" (107cm - 122cm) doors
- Door Opening Height: Standard door height 7' (213cm), with the device centerline at 39-15/16" (101cm) from floor
Optional heights up to 8' (244cm) by using rod extensions
- Door Thickness: 1-3/4" (44mm) standard. Refer to page 10 for other door thicknesses
- Minimum Stile Width: 4-1/2" (114mm)
- Projection: 2-1/2" (64mm) active, 1-3/4" (44mm) depressed
- Strike: Top: Roller type 791. Bottom: Flush mounted 790.
794 floor strike optional (threshold openings), 702 optional (Bottom Pullman Latch)
- Trims: 210F series utility trim, 420F series escutcheon trim, 440F series rose trim
- Dogging: Hex key dogging supplied standard on panic devices
- Finishes: 689, 691, 693, 695
- Options: Shim Kit #224, Sex Nuts and Bolts, Bottom Pullman Latch (panic only)
- Warranty: 1-year limited







outside trim lever designs

AU Augusta   Projection: 2-5/16" (59mm)	MO Monroe   Projection: 2-3/16" (71mm)	PB Pacific Beach   Projection: 2-3/4" (70mm)
--	--	---

420F series wide escutcheon trim

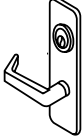
- Certified ANSI/BHMA A156.3, Grade 1. **BHMA CERTIFIED**
- Through-bolted. 1-3/4" (44mm) door standard. For doors thru 2-1/4" (57mm) or shim-mounted devices, specify on order.
- Dimensions: 2-1/2" x 9-1/2" x 1/4" (64mm x 241mm x 6mm).
- Cylinders not included. For rim cylinders, see pages 8-9.
- Finishes: 689, 691, 693, 695.
- 1-year warranty.
- Ordering Example: PB428F x LHR x 689.

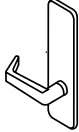
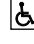
				 		 		
Applications	Cylinder	Exit Only Blank Plate	Nightlatch	Classroom/Storeroom	Nightlatch	Dummy Free Wheeling	Passage	Dummy Rigid Lever
1800(F) 1810(F)	Rim	420F	421F*	426F	427F*	428F	428F	429F
ANSI		01	03	08/09	03	02	14	02

***Not recommended for use with 1810(F) surface vertical rod exit devices.**
Note: 09 and Free Wheeling 02 achieved with single trim modification at installation.

outside trim

440F series rose trim

- Certified ANSI/BHMA A156.3, Grade 1.
- 440F rose trim for stock doors (161 Prep).
- 1-3/4" (44mm) door standard. For doors thru 2-1/4" (57mm) or shim-mounted devices, specify on order.
- Cylinders included, accepts component cylinders. See pages 8-9.
- Finishes: 626, 689, 691, 693, 695.
- "B" trim prefix – Lever trim accepting small format interchangeable cores (SFIC). Specify 6- or 7-pin.
(Example: B-AU446F)
- 2-year warranty.
- Ordering example: AU446F x RHR x 693.

	AU	MO	PB		
Applications	Nightlatch Access by Key	Classroom	Dummy Trim Free Wheeling Lever	Passage Lever	Dummy Trim Rigid Lever
1800(F) 1810(F)	441F	446F	448F	448F	449F
ANSI	03	08	02	14	02



210F series trim

- Through-bolted. 1-3/4" (44mm) door standard. For doors thru 2-1/4" (57mm) or shim-mounted devices, specify on order.
- Plate Dimensions: 3-1/2" x 3-3/4" x 3/32" (89mm x 95mm x 2mm).
- Finger Pull Dimensions: 3-1/2" x 6-3/4" x 1/8" (89mm x 171mm x 3mm).
- Cylinders not included. For rim cylinder options, see pages 8-9.
- Finishes: 689, 691, 693, 695.
- 1-year warranty.

Application	Cylinder	Nightlatch Access by Key	Dummy Trim Pull Plate	Nightlatch Cylinder x Pull
1800(F) 1810(F)	Rim	213F*	214F	217F*
ANSI		03	02	03

*Not recommended for use with 1810(F) surface vertical rod exit devices.

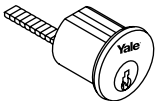
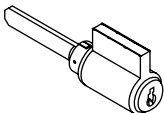
cylinders

Illustration	Type	Model Number	Number of Pins
	Cylinder used for trim series 210F and 420F	1109	6
	Cylinder used for trim series 440F	1802	6
	Cylinder used for KRM200(F)	2153	6

keying



All cylinders furnished standard 6-pin, keyed random in Yale® PARA keyway, pinned to *Yale* .019" specification. Each cylinder furnished with two nickel silver keys.

options

Cylinders available 0-bitted, keyed alike, master keyed or construction master keyed upon request.

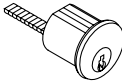
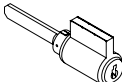
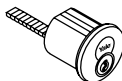

competitor keyway cylinders/cores

Illustration	Type	Model Number	Number of Pins (Specify)
	Best® Keyway Core. Available keyed random, master keyed or uncombined. Specify keyway A, B, C, D, E, F, G, H, J, K, L or M.	A600	6 or 7
	Schlage® "C" Keyway Cylinder. For use with 210F and 420F series trim. Available 0-bitted or keyed random.	2109	6
	Schlage® "C" Keyway Cylinder. For use with 440F series trim. Available 0-bitted or keyed random.	2802	6
	Rim SFIC Cylinder. Includes Best Keyway Core. For use with 210F and 420F series trim. Available keyed random, master keyed or uncombined. Specify keyway A, B, C, D, E, F, G, H, J, K, L or M.	A640	6 or 7 Specify Length: 1-1/4" (6-pin only) 1-3/8" (6- or 7-pin)
	Mortise SFIC Cylinder. Includes Best® Keyway Core. For use with Key Removable Mullion. Available keyed random, master keyed or uncombined. Specify keyway A, B, C, D, E, F, G, H, J, K, L or M.	A620	6 or 7 Specify Length: 1-1/4" (6-pin only) 1-3/8" (6- or 7-pin)
	Schlage® "C" Keyway Cylinder. For use with Key Removable Mullion. Available 0-bitted or keyed random.	2553	6

small format interchangeable core (SFIC)

Model/Prefix	Description	Length	Number of Pins (Specify)		Ordering Example
			6-Pin	7-Pin	
B-	Prefix for cylindrical lever with SFIC prep. Less core. For use with 440F series trim.	—	—	—	B-AU446F x 693
K680	Rim SFIC housing only. For use with 210F and 420F series trim.	1-1/4"	X	—	AU426F x K680 x 1-1/4" x 693
		1-3/8"	X	X	
K660	Mortise SFIC housing only. For use with Key Removable Mullion.	1-1/4"	X	—	KRM200F x K660 x 1-1/4"
		1-3/8"	X	X	

strikes

rim devices

<p>757F Standard strike for 1800(F) devices. Supplied with #10-24 x 3/4" machine screws, two shims (each 1/16" thick), and one locking plate.</p>	<p>793 Optional strike for double door applications without a mullion. Supplied with #10-24 x 3/4" machine screws, two shims (each 1/16" thick), and one locking plate.</p>

vertical rod devices - top strikes

<p>791 Standard top strike for 1810(F) devices. Supplied with #10-24 x 3/4" machine screws, two shims (each 1/16" thick), and one locking plate.</p>	<p>797 Optional bracket for mounting 791 top strike in flush transom opening. Supplied with 1/4-20 machine screws; SN-134 sex nuts, optional.</p>

vertical rod devices - bottom strikes

<p>790 Standard bottom strike for 1810(F) devices. Press in place.</p>	<p>794 Optional bottom strike for fire openings using saddle thresholds or for flush floor mount. Must use for fire openings with 1/2" thresholds. Supplied with #10-24 x 1/2" machine screws and floor anchors.</p>	<p>702 Optional bottom strike for bottom pullman latch option. Supplied with #8 x 8/32" combination screws.</p>



accessories

shim kits

Shim kits are available for devices on doors with interfacing molding. Each shim kit contains:

- 2 sets of 1/8" shims (shim up to 1/4")
- Longer fasteners
- Longer connecting bar for the trim
- Installation instructions

223 – Shim Kit for 1800(F) Series rim exit devices

224 – Shim Kit for 1810(F) Series surface vertical rod exit devices

extension rods

1810(F) surface vertical rod devices are supplied standard for 7' (213cm) standard. Rods may be field cut or used with extension rods for other heights. To order, specify:

Model Number	Length
2010-2	2" (51mm)
2010-6	6" (153mm)
2010-12	12" (305mm)

specialty fasteners

Sex Nuts:

Required for wood, composite or unreinforced metal doors. To order specify:

- SN-104 – pack of (4) 10-24 sex nuts for all fire rim exits
- SN-134 – pack of (4) 1/4-20 sex nuts for all devices

Wood Door Fasteners:

For solid core wood doors, permitted if pilot holes are used to install screws. Consult the factory for availability.

Torx® Security Screws available for factory product orders.

long tailpiece kit

Long tailpiece kit for use with escutcheon series trim, up to 4-1/2" thick doors. Specify part number to order.

Door Thickness	Trim Type	Part Number
2" - 2-1/2"	420F Series Trim	81-9500-1665-000
2-1/2" - 3-1/2"	420F Series Trim	81-9500-1635-000
3-1/2" - 4-1/2"	420F Series Trim	81-9500-1636-000

bottom pullman latch

Optional bottom Pullman latch available for panic-listed vertical rod exit devices. To order with devices, specify "BPL." 702 bottom strike required, see page 10.

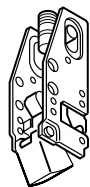



mullions

M200(F) removable mullion

M200(F) mullions are for use with 1800(F) Series exit devices. Mullions may be field cut to fit opening. Red primer finish.

- **M200 Removable Mullion**
For Panic Exits. Tubular steel, 2" x 3" (51mm x 76mm). Specify 7', 8', or 10'.
- **M200F Removable Mullion**
For Fire Exits. Tubular steel, 2" x 3" (51mm x 76mm). Specify 7' or 8'.

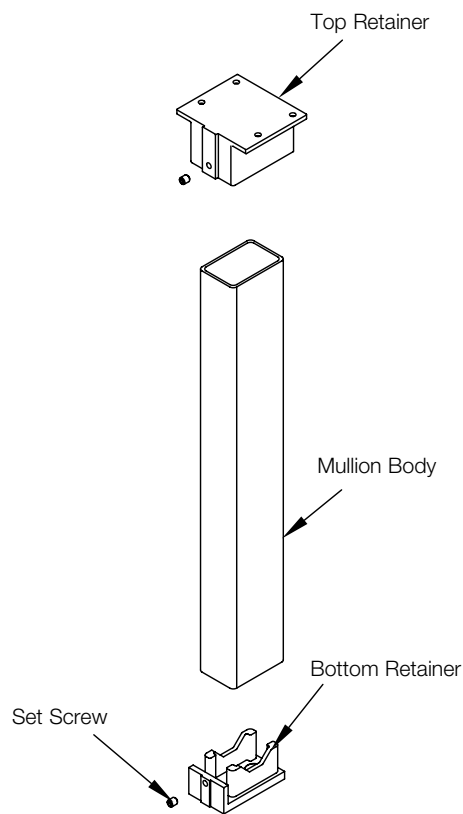

M200(F) options

- **M203 Spacer Block**
Recommended for double rabbeted frames where the stop face width is less than the mounting hole spacing or for applications with 5-3/4" (146mm) or less door frames.

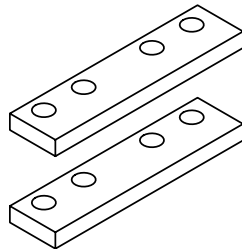

- **M204 Angle Bracket**
Recommended for any header configuration with less than 3" (76mm) of mounting surface.

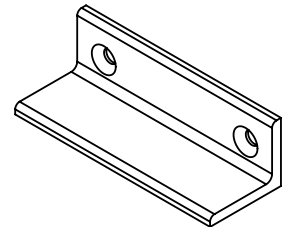

mullions

keyed removable mullion (KRM)

Keyed removable mullions are for use with 1800(F) Series exit devices. They are designed for simple removing when an unobstructed large opening is required and easy replacement and locking to maintain the integrity of the opening.

- KRM200 Keyed Removable Mullion for Panic Exits. Specify 7', 8', or 10'.
- KRM200F Keyed Removable Mullion for Fire Exits. Specify 7' or 8'.

krm features

- Easy cylinder installation.
- Mullion automatically relocks when reinstalled without the use of the cylinder key.
- When ordering, add KR prefix to mullion, example: KRM200 and KRM200F.

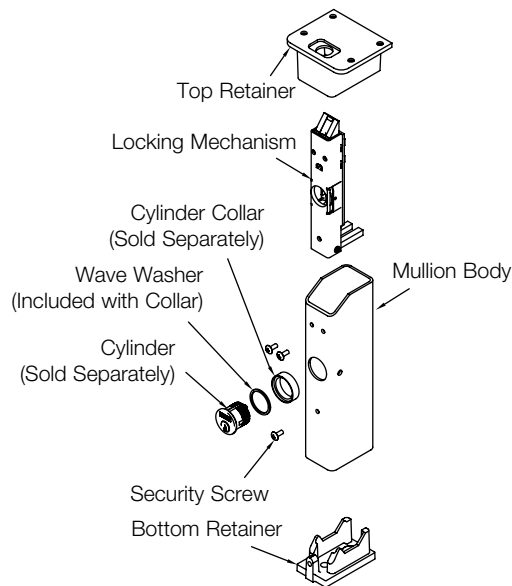

krm options

- **M203 Spacer Block**

Recommended for double rabbeted frames where the stop face width is less than the mounting hole spacing or for applications with 5-3/4" (146mm) or less door frames.

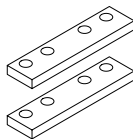

- **M204 Angle Bracket**

Recommended for any header configuration with less than 3" (76mm) of mounting surface.

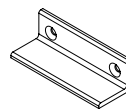

krm cylinders

As with any exit device trim, you must order a cylinder and collar if one is required. The Yale® keyed removable mullion accepts a mortise cylinder. Refer below and to pages 8-9 for details.

krm collars

Cylinder Model #	Length	Collar Requirement
2153 or 2553	1-1/4"	1765.312
A620 or K660	1-1/4"	1765.406
	1-3/8"	1765.563

how to order

18	1	X	0	Suffix	-XX	Outside Trim	Finish	Other Info
		Third Digit: "0" - Rim Device "1" - SVR Device		Trim Suffix: No Suffix - Panic label "F" - Fire label	Size: (DOW=Door Opening Width) "36" - 30" to 36" (76cm to 91cm) "42" - 36" to 42" (91cm to 107cm) "48" - 42" to 48" (107cm to 122cm)	Trim Model Number See pages 6-7	626 689 691 693 695	Other Information: Door Hand - RHR or LHR (SVR or Lever Escutcheon Trim only). Devices are field reversible. SN-134, 1/4-20 Sex Nuts (pack of 4). SN-104, 10-24 Sex Nuts (pack of 4). Door Thickness: over 1-3/4" (45mm). Rod Extensions: (quantity) 2010-2 (quantity) 2010-6 (quantity) 2010-12 Shim Kits: (quantity) 223 (quantity) 224 Optional Strike (page 10) Removable Mullion: M200 (Panic) M200F (Fire) KRM200 (Panic) KRM200F (Fire) Factory Keying Bottom Pullman Latch (SVR Devices)

Notes:

- It is recommended that exit devices and trim for the same opening be ordered together.
- Standard product is for 1-3/4" (45mm) reinforced metal doors.
- Accessories detached from the device and trim should be specified separately.
- 626 finish offered for 440F series trim only.



1800 series | grade 1 exit devices

notes

online literature and templates

For the latest information on Yale Locks & Hardware products, visit our website at: www.yalelocks.com

Click on the "Product Information" button to find:

- Catalogs
- Parts manuals
- Templates
- Specifications
- Installation instructions

Yale® customers can click on the ebusiness symbol  on the website to register for an ebusiness account to:

- Check the status of orders
- Check availability of Quick-Ship items
- Track your order and confirm delivery
- Receive email notification of template changes
- And More...

Or contact us at:

U.S.A.

Yale Locks & Hardware

Address: 100 Yale Avenue, Lenoir City, TN 37771-3226
Tel: 1-800-438-1951 • Fax: 1-800-338-0965 • www.yalelocks.com

Canada:

ASSA ABLOY Door Security Solutions Canada

Address: 160 Four Valley Drive, Vaughan, Ontario L4K 4T9
Tel: 1-800-461-3007 • Fax: 1-800-461-8989 • www.assaabloy.ca

International:

ASSA ABLOY Americas International

Tel: 1-905-821-7775 • Fax: 1-905-821-1429 • www.assaabloyai.com

Yale Locks & Hardware is a division of Yale Security Inc., an ASSA ABLOY Group company.

Yale® is a registered trademark of Yale Security Inc., an ASSA ABLOY Group company. Other products' brand names may be trademarks or registered trademarks of their respective owners and are mentioned for reference purposes only. These materials are protected under U.S. copyright laws. All contents current at time of publication. Yale Security Inc. reserves the right to change availability of any item in this catalog, its design, construction, and/or its materials. Copyright © 2010, 2011, Yale Security Inc., an ASSA ABLOY Group company. All rights reserved. Reproduction in whole or in part without the express written permission of the Yale Security Inc., an ASSA ABLOY Group company, is prohibited.

YALE, with its unique global reach and range of products, is the world's favorite lock.

ASSA ABLOY is the global leader in door opening solutions, dedicated to satisfying end-user needs for security, safety and convenience.

42703-12/11R